

ENGINE WIRE HARNESS, Gi

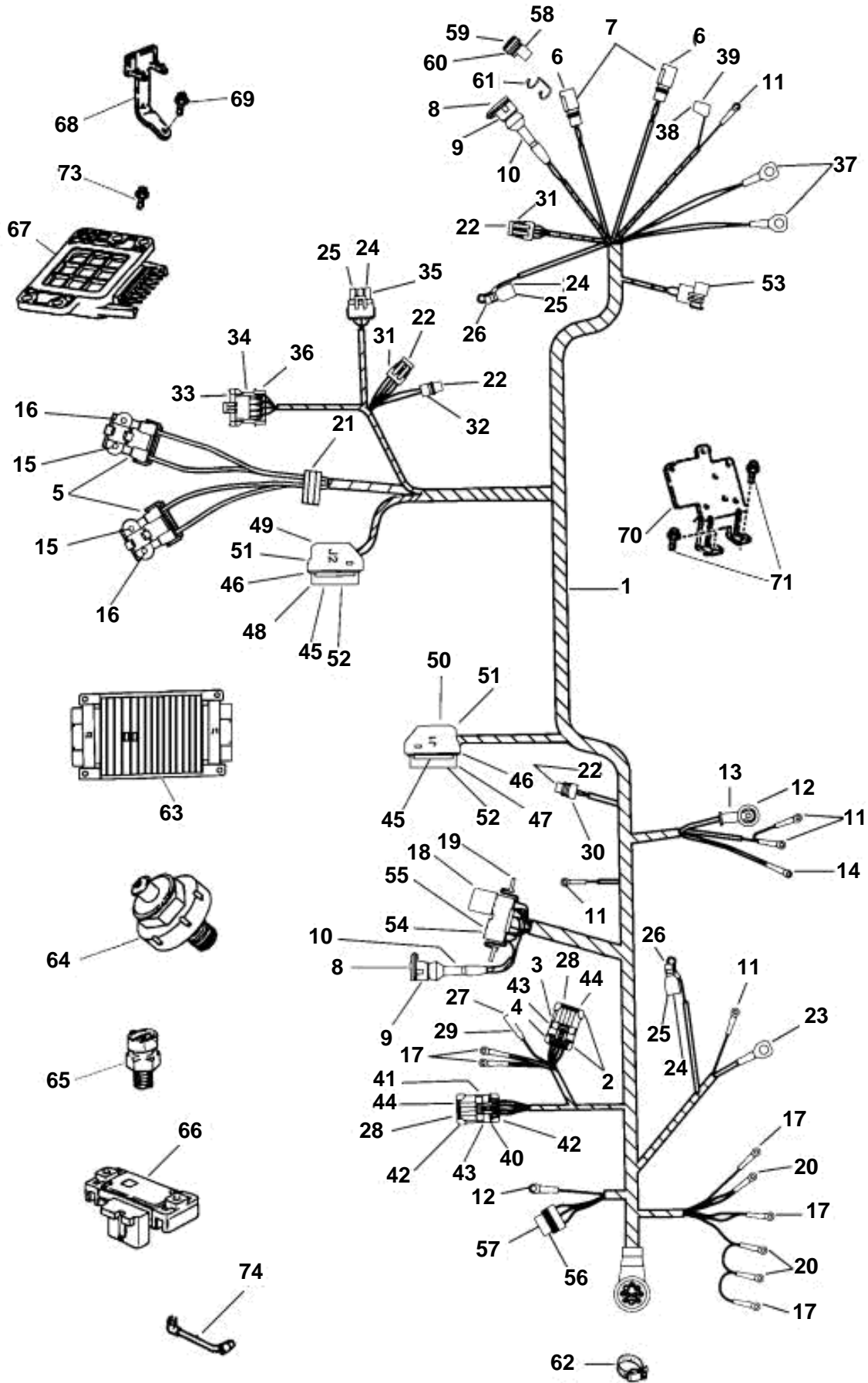

ENGINE WIRE HARNESS, Gi

| REF | PART NO. | QTY | DESCRIPTION | NOTES |
|-----|----------|-----|-----------------------------------|--|
| 1 | 3854876 | 1 | Cable harness, Engine | |
| 2 | 3855263 | 2 | Cap, 4-pin connector | |
| 3 | 3855240 | 1 | Connector, 4-pin | |
| 4 | 3855239 | 1 | Connector, 4-pin | |
| 5 | 3855250 | 2 | Connector, Injector | |
| 6 | 3852229 | 4 | Cable terminal, Pin | |
| 7 | 3853565 | 2 | Connector, 2-pin | |
| 8 | 3853679 | 4 | Cable terminal | |
| 9 | 3855021 | 2 | Housing | |
| 10 | 3853681 | 2 | Cover, Fuel pump | |
| 11 | 3852233 | 5 | Cable terminal | |
| 12 | 3852107 | 2 | Cable terminal | |
| 13 | 3852130 | 1 | Rubber cap, Alternator | |
| 14 | 3852036 | 1 | Cable terminal, Alternator ground | |
| 15 | 3855237 | 4 | Cable terminal, Injector | |
| 16 | 3855238 | 4 | Seal, Injector | |
| 17 | 3852235 | 5 | Cable terminal | |
| 18 | 3850403 | 2 | Relay, Fuel pump | |
| 19 | 3852210 | 1 | Bracket, Relay | |
| 20 | 3854245 | 3 | Cable terminal | |
| 21 | 3855241 | 1 | Grommet | |
| 22 | 3855242 | 13 | Cable terminal | |
| 23 | 3855022 | 1 | Cable terminal, Starter | |
| 24 | 3855023 | 3 | Cable terminal, Sensor | |
| 25 | 3853478 | 8 | Seal, Terminal | |
| 26 | 3853480 | 1 | Terminal casing, Knock sensor | |
| 27 | 3855024 | 1 | Cable terminal, Ignition cutoff | |
| 28 | 3855243 | 9 | Seal, Connector | |
| 29 | 3855025 | 1 | Cable sleeve, Terminal | |
| 30 | 3855244 | 1 | Connector, Temperature switch | |
| 31 | 3855027 | 2 | Cable terminal, 4-terminal | |
| 32 | 3855245 | 1 | Connector, 3-terminal | |
| 33 | 3855246 | 1 | Cable terminal, Spark control | |
| 34 | 3855247 | 1 | Connector, Spark control | |
| 35 | 3855248 | 1 | Connector, MAP sensor | |
| 36 | 3855249 | 1 | Connector, 5-pin connector | |
| 37 | 3852527 | 2 | Cable terminal, Ground | |
| 38 | 3852084 | 1 | Cable terminal, Oil switch | |
| 39 | 3853320 | 1 | Cover, Terminal | |
| 40 | 3855251 | 1 | Connector | |
| 41 | 3855252 | 1 | Connector | |
| 42 | 3855253 | 2 | Cap | |
| 43 | 3855267 | 9 | Cable terminal | |
| 44 | 3855254 | 19 | Plug | |
| 45 | 3855255 | 2 | Connector, Connector | |
| 46 | 3855256 | 2 | Seal | |
| 47 | 3855257 | 1 | Connector, Connector, J1 module | |
| 48 | 3855258 | 1 | Connector, Connector, J2 module | |
| 49 | 3855259 | 1 | Connector housing, J2 module | |
| 50 | 3855260 | 1 | Connector housing, J1 module | |
| 51 | 3855261 | 28 | Plug | |
| 52 | 3855262 | 36 | Cable terminal | |
| 53 | 3854244 | 1 | Cable, Ignition coil | |
| 54 | 3852246 | 5 | Cable terminal, Relay | |
| 55 | 3852247 | 3 | Cable terminal, Relay | |
| 56 | 3854192 | 1 | Connector, Starter solenoid | |
| 57 | 3852254 | 4 | Cable terminal, Starter solenoid | |
| 58 | 3855178 | 1 | Connector, Slave | |
| 59 | 3852230 | 2 | Plug | |
| 60 | 3853564 | 1 | Connector | |
| 61 | 3852237 | 1 | Retainer, Connector | |
| 62 | 3853786 | 1 | Clamp, Instrument cable | |
| 63 | 3854779 | 1 | Ecu, Electronic control | PNCA, PNCM, JNCS, PNCACE, PNCMCE only |
| | 3855760 | 1 | Ecu, Electronic control | PNCB, JNCC, PNCS, PNCBCE, PNCSCCE only |

7797210 - - 0-0008

GR960058

Upd: 15 FEB 2006

NC 4.3 GL, 4.3 GS, 4.3 Gi

VOLVO
PENTA

ENGINE WIRE HARNESS, Gi

| REF | PART NO. | QTY | DESCRIPTION | NOTES |
|-----|----------|-----|--------------------------------|--|
| 64 | 3854905 | 1 | Sensor | |
| 65 | 3850397 | 1 | Ect sensor | |
| 66 | 3850396 | 1 | Sender | |
| 67 | 3854672 | 1 | Control unit, Knock sensor | |
| 68 | 3850272 | 1 | Bracket, Knock module | |
| 69 | 3852115 | 2 | Screw, Bracket, knock module | |
| 70 | 3851990 | 1 | Bracket, ECM and MAP sensor | |
| 71 | 3852115 | 2 | Screw, MAP sensor bracket | |
| 72 | 3852115 | 4 | Screw, ECM to bracket | PNCA, PNCM, JNCS, PNCACE, PNCMCE only |
| | 3855578 | 4 | Screw, ECM to bracket | PNCB, JNCC, PNCS, PNCBCE, PNCSCCE only |
| 73 | 3852115 | 4 | Screw, Knock module to bracket | |
| 74 | 3850688 | 4 | Hose, MAP sensor | |